

## OASIS ACADEMY - COULSDON

**Project:** Oasis Academy, Coulsdon

**Client:** Kier Education

**Value:** £20.5m

ACP took second place in the bid for the 1150 pupil Oasis Academy in Coulsdon Surrey with Kier Education for the transformation of a tired school campus into a vibrant new Academy.

The design solution successfully builds upon the retained elements of the existing school and integrates them into a compact 'new' academy. It replaces the linearity, long narrow corridors, dead ends and crowded circulation prevalent in the existing school with a stunning three storey 'Agora' surrounded by the five flexible learning zones and core facilities with particular emphasis on the core Science and Technology specialism.

The 'Agora', at the heart of the Academy, provides, in addition to a cybercafé, LRC, staff work/break-out, a space capable of holding a 500 person assembly, a catwalk for fashion shows, exhibition area, group learning and demonstration area, performance space and where students will be able to enjoy a refreshing cafe area in soft relaxing furniture while they either link to the www or read a classic hardback or the newspaper. Glazed shop-fronts bring science, art, design and technology directly into the Agora, with the transparency repeating at the upper levels.

The 'Academy Mall' along the entrance approach is a shop-front that advertises the success and enthusiasm of the learning environment by extensive display and exhibition placing the school specialism's of Science, Technology and Business on display even before the user enters the Academy.

High quality landscaping carefully integrates alongside the internal learning spaces. Hard surfaced 'cells' for students to learn outdoors, external dining, recreation spaces of differing sizes broken up by soft landscaped margins. The green setting of the existing school has been developed to encourage biodiversity, while the inclusion of an amphitheatre offers another very adaptable space for drama, English, PE coaching and demonstration and social uses.

Architects: Architects Co-Partnership  
 Structural Eng: BDP  
 M&E Consultants: BDP  
 Landscape Arch: EDCO  
 Contractor: Kier London



*Aerial View from Main Entrance*

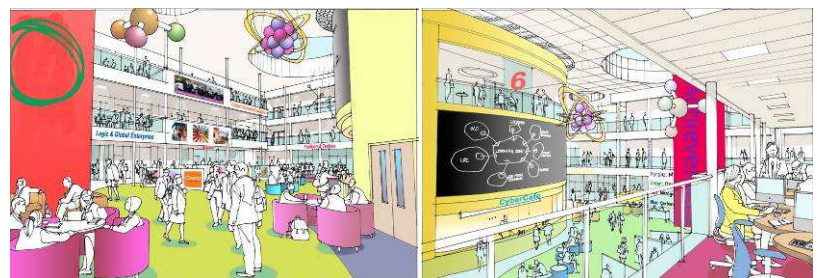

*'Agora' Heart Space from Entrance*

*Agora' Heart Space at First Floor*



*Landscape and External Learning*



*Main Entrance and 'Academy Mall'*



*Internal Section through Agora and Lecture Theatre/Demonstration Suite*



*Internal Section through Agora*